

W14/201716408



Epping Forest
Application for a premises licence
Licensing Act 2003

For help contact
licensing@eppingforestdc.gov.uk
Telephone: 01992 564000

* required information

Section 1 of 21

You can save the form at any time and resume it later. You do not need to be logged in when you resume.

System reference

Not Currently In Use

This is the unique reference for this application generated by the system.

Your reference

Vivaldi

You can put what you want here to help you track applications if you make lots of them. It is passed to the authority.

Are you an agent acting on behalf of the applicant?

Yes

No

Put "no" if you are applying on your own behalf or on behalf of a business you own or work for.

Applicant Details

* First name

Mr Irfan

* Family name

Tas

* E-mail

[Redacted]

Main telephone number

[Redacted]

Include country code.

Other telephone number

[Redacted]

Indicate here if the applicant would prefer not to be contacted by telephone

Is the applicant:

Applying as a business or organisation, including as a sole trader

Applying as an individual

A sole trader is a business owned by one person without any special legal structure. Applying as an individual means the applicant is applying so the applicant can be employed, or for some other personal reason, such as following a hobby.

Continued from previous page...

Address

* Building number or name

* Street

District

* City or town

County or administrative area

* Postcode

* Country



Agent Details

* First name

Mrs Aysen

* Family name

Ipek Kilic

* E-mail



Main telephone number



Include country code.

Other telephone number

Indicate here if you would prefer not to be contacted by telephone

Are you:

- An agent that is a business or organisation, including a sole trader
- A private individual acting as an agent

A sole trader is a business owned by one person without any special legal structure.

Agent Business

Is your business registered in the UK with Companies House?

- Yes
- No

Note: completing the Applicant Business section is optional in this form.

Registration number

1004572

Business name

Narts Food and Leisure Limited

If your business is registered, use its registered name.

VAT number

- None

Put "none" if you are not registered for VAT.

Legal status

Private Limited Company

Your position in the business

Licensing Consultant

Home country

United Kingdom

The country where the headquarters of your business is located.

Continued from previous page...

Agent Registered Address

Address registered with Companies House.

Building number or name	53
Street	Stoke Newington High Street
District	
City or town	London
County or administrative area	
Postcode	N16 8EL
Country	United Kingdom

Section 2 of 21

PREMISES DETAILS

I/we, as named in section 1, apply for a premises licence under section 17 of the Licensing Act 2003 for the premises described in section 2 below (the premises) and I/we are making this application to you as the relevant licensing authority in accordance with section 12 of the Licensing Act 2003.

Premises Address

Are you able to provide a postal address, OS map reference or description of the premises?

Address OS map reference Description

Postal Address Of Premises

Building number or name	Vivaldi
Street	236 High Road
District	
City or town	Loughton
County or administrative area	
Postcode	IG10 1RB
Country	United Kingdom

Further Details

Telephone number	
Non-domestic rateable value of premises (£)	35,750

Section 3 of 21

APPLICATION DETAILS

In what capacity are you applying for the premises licence?

- An individual or individuals
- A limited company / limited liability partnership
- A partnership (other than limited liability)
- An unincorporated association
- Other (for example a statutory corporation)
- A recognised club
- A charity
- The proprietor of an educational establishment
- A health service body
- A person who is registered under part 2 of the Care Standards Act 2000 (c14) in respect of an independent hospital in Wales
- A person who is registered under Chapter 2 of Part 1 of the Health and Social Care Act 2008 in respect of the carrying on of a regulated activity (within the meaning of that Part) in an independent hospital in England
- The chief officer of police of a police force in England and Wales

Confirm The Following

- I am carrying on or proposing to carry on a business which involves the use of the premises for licensable activities
- I am making the application pursuant to a statutory function
- I am making the application pursuant to a function discharged by virtue of Her Majesty's prerogative

Section 4 of 21

INDIVIDUAL APPLICANT DETAILS

Applicant Name

Is the name the same as (or similar to) the details given in section one?

- Yes No

If "Yes" is selected you can re-use the details from section one, or amend them as required. Select "No" to enter a completely new set of details.

First name

Family name

Is the applicant 18 years of age or older?

- Yes No

Continued from previous page...

Current Residential Address

Is the address the same as (or similar to) the address given in section one?

If "Yes" is selected you can re-use the details from section one, or amend them as required. Select "No" to enter a completely new set of details.

Yes No

Building number or name

Street

District

City or town

County or administrative area

Postcode

Country



Applicant Contact Details

Are the contact details the same as (or similar to) those given in section one?

If "Yes" is selected you can re-use the details from section one, or amend them as required. Select "No" to enter a completely new set of details.

Yes No

E-mail



Telephone number

Other telephone number

* Date of birth

dd mm yyyy

* Nationality

Documents that demonstrate entitlement to work in the UK

Section 5 of 21

OPERATING SCHEDULE

When do you want the premises licence to start?

 / /
dd mm yyyy

If you wish the licence to be valid only for a limited period, when do you want it to end

 / /
dd mm yyyy

Provide a general description of the premises

For example the type of premises, its general situation and layout and any other information which could be relevant to the licensing objectives. Where your application includes off-supplies of alcohol and you intend to provide a place for consumption of these off-supplies you must include a description of where the place will be and its proximity to the premises.

A Cafe Restaurant serving French, Italian and Mexican foods.

Continued from previous page...

If 5,000 or more people are expected to attend the premises at any one time, state the number expected to attend

Section 6 of 21

PROVISION OF PLAYS

See guidance on regulated entertainment

Will you be providing plays?

- Yes No

Section 7 of 21

PROVISION OF FILMS

See guidance on regulated entertainment

Will you be providing films?

- Yes No

Section 8 of 21

PROVISION OF INDOOR SPORTING EVENTS

See guidance on regulated entertainment

Will you be providing indoor sporting events?

- Yes No

Section 9 of 21

PROVISION OF BOXING OR WRESTLING ENTERTAINMENTS

See guidance on regulated entertainment

Will you be providing boxing or wrestling entertainments?

- Yes No

Section 10 of 21

PROVISION OF LIVE MUSIC

See guidance on regulated entertainment

Will you be providing live music?

- Yes No

Section 11 of 21

PROVISION OF RECORDED MUSIC

See guidance on regulated entertainment

Will you be providing recorded music?

- Yes No

Section 12 of 21

PROVISION OF PERFORMANCES OF DANCE

Continued from previous page...

See guidance on regulated entertainment

Will you be providing performances of dance?

Yes

No

Section 13 of 21

PROVISION OF ANYTHING OF A SIMILAR DESCRIPTION TO LIVE MUSIC, RECORDED MUSIC OR PERFORMANCES OF DANCE

See guidance on regulated entertainment

Will you be providing anything similar to live music, recorded music or performances of dance?

Yes

No

Section 14 of 21

LATE NIGHT REFRESHMENT

Will you be providing late night refreshment?

Yes

No

Standard Days And Timings

MONDAY

Start

End

Start

End

TUESDAY

Start

End

Start

End

WEDNESDAY

Start

End

Start

End

THURSDAY

Start

End

Start

End

FRIDAY

Start

End

Start

End

SATURDAY

Start

End

Start

End

Give timings in 24 hour clock.
(e.g., 16:00) and only give details for the days
of the week when you intend the premises
to be used for the activity.

Continued from previous page...

SUNDAY

Start

End

Start

End

Will the provision of late night refreshment take place indoors or outdoors or both?

- Indoors Outdoors Both

Where taking place in a building or other structure tick as appropriate. Indoors may include a tent.

State type of activity to be authorised, if not already stated, and give relevant further details, for example (but not exclusively) whether or not music will be amplified or unamplified.

N/A

State any seasonal variations

For example (but not exclusively) where the activity will occur on additional days during the summer months.

N/A

Non-standard timings. Where the premises will be used for the supply of late night refreshments at different times from those listed in the column on the left, list below

For example (but not exclusively), where you wish the activity to go on longer on a particular day e.g. Christmas Eve.

N/A

Section 15 of 21

SUPPLY OF ALCOHOL

Will you be selling or supplying alcohol?

- Yes No

Standard Days And Timings

MONDAY

Start

End

Start

End

Give timings in 24 hour clock. (e.g., 16:00) and only give details for the days of the week when you intend the premises to be used for the activity.

Continued from previous page...

TUESDAY

Start	<input type="text" value="09:00"/>	End	<input type="text" value="23:00"/>
Start	<input type="text"/>	End	<input type="text"/>

WEDNESDAY

Start	<input type="text" value="09:00"/>	End	<input type="text" value="23:00"/>
Start	<input type="text"/>	End	<input type="text"/>

THURSDAY

Start	<input type="text" value="09:00"/>	End	<input type="text" value="23:00"/>
Start	<input type="text"/>	End	<input type="text"/>

FRIDAY

Start	<input type="text" value="09:00"/>	End	<input type="text" value="23:00"/> 00:00
Start	<input type="text"/>	End	<input type="text"/>

SATURDAY

Start	<input type="text" value="09:00"/>	End	<input type="text" value="00:00"/>
Start	<input type="text"/>	End	<input type="text"/>

SUNDAY

Start	<input type="text" value="09:00"/>	End	<input type="text" value="23:00"/> 23:00
Start	<input type="text"/>	End	<input type="text"/>

Will the sale of alcohol be for consumption:

- On the premises Off the premises Both

If the sale of alcohol is for consumption on the premises select on, if the sale of alcohol is for consumption away from the premises select off. If the sale of alcohol is for consumption on the premises and away from the premises select both.

State any seasonal variations

For example (but not exclusively) where the activity will occur on additional days during the summer months.

N/A

Non-standard timings. Where the premises will be used for the supply of alcohol at different times from those listed in the column on the left, list below

For example (but not exclusively), where you wish the activity to go on longer on a particular day e.g. Christmas Eve.

N/A

Continued from previous page...

State the name and details of the individual whom you wish to specify on the licence as premises supervisor

Name

First name

Family name

Date of birth

Enter the contact's address

Building number or name

Street

District

City or town

County or administrative area

Postcode

Country

Personal Licence number (if known)

Issuing licensing authority (if known)

PROPOSED DESIGNATED PREMISES SUPERVISOR CONSENT

How will the consent form of the proposed designated premises supervisor be supplied to the authority?

- Electronically, by the proposed designated premises supervisor
- As an attachment to this application

Reference number for consent form (if known)

If the consent form is already submitted, ask the proposed designated premises supervisor for its 'system reference' or 'your reference'.

Section 16 of 21

ADULT ENTERTAINMENT

Highlight any adult entertainment or services, activities, or other entertainment or matters ancillary to the use of the premises that may give rise to concern in respect of children

Give information about anything intended to occur at the premises or ancillary to the use of the premises which may give rise to concern in respect of children, regardless of whether you intend children to have access to the premises, for example (but not exclusively) nudity or semi-nudity, films for restricted age groups etc gambling machines etc.

N/A

Continued from previous page...

Section 17 of 21

HOURS PREMISES ARE OPEN TO THE PUBLIC

Standard Days And Timings

MONDAY

Start 09:00

End 23:30

Start

End

Give timings in 24 hour clock.
(e.g., 16:00) and only give details for the days
of the week when you intend the premises
to be used for the activity.

TUESDAY

Start 09:00

End 23:30

Start

End

WEDNESDAY

Start 09:00

End 23:30

Start

End

THURSDAY

Start 09:00

End 23:30

Start

End

FRIDAY

Start 09:00

End 00:30

Start

End

SATURDAY

Start 09:00

End 00:30

Start

End

SUNDAY

Start 09:00

End 23:30

Start

End

State any seasonal variations

For example (but not exclusively) where the activity will occur on additional days during the summer months.

N/A

Continued from previous page...

Non standard timings. Where you intend to use the premises to be open to the members and guests at different times from those listed in the column on the left, list below

For example (but not exclusively), where you wish the activity to go on longer on a particular day e.g. Christmas Eve.

N/A

Section 18 of 21

LICENSING OBJECTIVES

Describe the steps you intend to take to promote the four licensing objectives:

a) General – all four licensing objectives (b,c,d,e)

List here steps you will take to promote all four licensing objectives together.

Please see below conditions proposed to promote the licensing objectives.

b) The prevention of crime and disorder

An incident book shall be available for inspection at all reasonable times by an authorised officer of relevant responsible authority. The records will be retained for at least 12 months.

The CCTV equipment shall be maintained in good working order and continually record when licensable activity takes place and for a period of two hours afterwards.

The CCTV system shall cover all areas of the premises to which the public have access including any outside areas. Images shall be retained for a minimum of 31 days

c) Public safety

All staff have received suitable training as to what to do in an emergency and in general safety precautions.

d) The prevention of public nuisance

All the rubbish produced by the premises shall be stored securely in a designated area or in a bin with a tight fitting and lockable lid.

The 'collection and removal of litter' shall be taken to include the satisfactory disposal of spilled food and similar materials so as to leave the footway in a clean, safe and wholesome condition.

Regular maintenance will be carried out on all plant and machinery to ensure that noise disturbance from such sources is kept to a minimum.

Ventilation equipment will be regularly cleaned and maintained to control the levels of odour generated by the premises.

e) The protection of children from harm

Continued from previous page...

All staff shall receive induction and refresher training (at least every three months) relating to the sale of alcohol and the times and conditions of the premises licence.

All training relating to the sale of alcohol and times and conditions of the premises licence shall be documented and records kept at the premises. These records shall be made available to the Police and/or Local Authority upon request and shall be kept for at least one year.

A written record of refused sales shall be kept on the premises and completed when necessary. This record shall be made available to Police and/or the Local Authority upon request and shall be kept for at least one year from the date of the last entry.

Section 19 of 21

NOTES ON DEMONSTRATING ENTITLEMENT TO WORK IN THE UK

Continued from previous page...

Entitlement to work/immigration status for individual applicants and applications from partnerships which are not limited liability partnerships:

A licence may not be held by an individual or an individual in a partnership who is resident in the UK who:

- does not have the right to live and work in the UK; or
- is subject to a condition preventing him or her from doing work relating to the carrying on of a licensable activity.

Any premises licence issued in respect of an application made on or after 6 April 2017 will become invalid if the holder ceases to be entitled to work in the UK.

Applicants must demonstrate that they have an entitlement to work in the UK and are not subject to a condition preventing them from doing work relating to the carrying on of a licensable activity. They do this by providing with this application copies or scanned copies of the following documents (which do not need to be certified).

Documents which demonstrate entitlement to work in the UK

- An expired or current passport showing the holder, or a person named in the passport as the child of the holder, is a British citizen or a citizen of the UK and Colonies having the right of abode in the UK [please see note below about which sections of the passport to copy].
- An expired or current passport or national identity card showing the holder, or a person named in the passport as the child of the holder, is a national of a European Economic Area country or Switzerland.
- A Registration Certificate or document certifying permanent residence issued by the Home Office to a national of a European Economic Area country or Switzerland.
- A Permanent Residence Card issued by the Home Office to the family member of a national of a European Economic Area country or Switzerland.
- A current Biometric Immigration Document (Biometric Residence Permit) issued by the Home Office to the holder indicating that the person named is allowed to stay indefinitely in the UK, or has no time limit on their stay in the UK.
- A current passport endorsed to show that the holder is exempt from immigration control, is allowed to stay indefinitely in the UK, has the right of abode in the UK, or has no time limit on their stay in the UK.
- A current Immigration Status Document issued by the Home Office to the holder with an endorsement indicating that the named person is allowed to stay indefinitely in the UK or has no time limit on their stay in the UK, when produced in combination with an official document giving the person's permanent National Insurance number and their name issued by a Government agency or a previous employer.
- A full birth or adoption certificate issued in the UK which includes the name(s) of at least one of the holder's parents or adoptive parents, when produced in combination with an official document giving the person's permanent National Insurance number and their name issued by a Government agency or a previous employer.
- A birth or adoption certificate issued in the Channel Islands, the Isle of Man or Ireland when produced in combination with an official document giving the person's permanent National Insurance number and their name issued by a Government agency or a previous employer.
- A certificate of registration or naturalisation as a British citizen, when produced in combination with an official document giving the person's permanent National Insurance number and their name issued by a Government agency or a previous employer.
- A current passport endorsed to show that the holder is allowed to stay in the UK and is currently allowed to work and is not subject to a condition preventing the holder from doing work relating to the carrying on of a licensable activity.

Continued from previous page...

- A current Biometric Immigration Document (Biometric Residence Permit) issued by the Home Office to the holder which indicates that the named person can currently stay in the UK and is allowed to work relation to the carrying on of a licensable activity.
- A current Residence Card issued by the Home Office to a person who is not a national of a European Economic Area state or Switzerland but who is a family member of such a national or who has derivative rights or residence.
- A current Immigration Status Document containing a photograph issued by the Home Office to the holder with an endorsement indicating that the named person may stay in the UK, and is allowed to work and is not subject to a condition preventing the holder from doing work relating to the carrying on of a licensable activity when produced in combination with an official document giving the person's permanent National Insurance number and their name issued by a Government agency or a previous employer.
- A Certificate of Application, less than 6 months old, issued by the Home Office under regulation 17(3) or 18A (2) of the Immigration (European Economic Area) Regulations 2006, to a person who is not a national of a European Economic Area state or Switzerland but who is a family member of such a national or who has derivative rights of residence.
- Reasonable evidence that the person has an outstanding application to vary their permission to be in the UK with the Home Office such as the Home Office acknowledgement letter or proof of postage evidence, or reasonable evidence that the person has an appeal or administrative review pending on an immigration decision, such as an appeal or administrative review reference number.
- Reasonable evidence that a person who is not a national of a European Economic Area state or Switzerland but who is a family member of such a national or who has derivative rights of residence in exercising treaty rights in the UK including:-
 - evidence of the applicant's own identity – such as a passport,
 - evidence of their relationship with the European Economic Area family member – e.g. a marriage certificate, civil partnership certificate or birth certificate, and
 - evidence that the European Economic Area national has a right of permanent residence in the UK or is one of the following if they have been in the UK for more than 3 months:
 - (i) working e.g. employment contract, wage slips, letter from the employer,
 - (ii) self-employed e.g. contracts, invoices, or audited accounts with a bank,
 - (iii) studying e.g. letter from the school, college or university and evidence of sufficient funds; or
 - (iv) self-sufficient e.g. bank statements.

Family members of European Economic Area nationals who are studying or financially independent must also provide evidence that the European Economic Area national and any family members hold comprehensive sickness insurance in the UK. This can include a private medical insurance policy, an EHIC card or an S1, S2 or S3 form.

Original documents must not be sent to licensing authorities. If the document copied is a passport, a copy of the following pages should be provided:-

- (i) any page containing the holder's personal details including nationality;
- (ii) any page containing the holder's photograph;
- (iii) any page containing the holder's signature;
- (iv) any page containing the date of expiry; and
- (v) any page containing information indicating the holder has permission to enter or remain in the UK and is permitted to work.

If the document is not a passport, a copy of the whole document should be provided.

Your right to work will be checked as part of your licensing application and this could involve us checking your immigration status with the Home Office. We may otherwise share information with the Home Office. Your licence application will not be determined until you have complied with this guidance.

Section 20 of 21

NOTES ON REGULATED ENTERTAINMENT

Continued from previous page...

In terms of specific regulated entertainments please note that:

- **Plays:** no licence is required for performances between 08:00 and 23:00 on any day, provided that the audience does not exceed 500.
- **Films:** no licence is required for 'not-for-profit' film exhibition held in community premises between 08:00 and 23:00 on any day provided that the audience does not exceed 500 and the organiser (a) gets consent to the screening from a person who is responsible for the premises; and (b) ensures that each such screening abides by age classification ratings.
- **Indoor sporting events:** no licence is required for performances between 08:00 and 23:00 on any day, provided that the audience does not exceed 1000.
- **Boxing or Wrestling Entertainment:** no licence is required for a contest, exhibition or display of Greco-Roman wrestling, or freestyle wrestling between 08:00 and 23:00 on any day, provided that the audience does not exceed 1000. Combined fighting sports – defined as a contest, exhibition or display which combines boxing or wrestling with one or more martial arts – are licensable as a boxing or wrestling entertainment rather than an indoor sporting event.
- **Live music:** no licence permission is required for:
 - o a performance of unamplified live music between 08:00 and 23:00 on any day, on any premises.
 - o a performance of amplified live music between 08:00 and 23:00 on any day on premises authorised to sell alcohol for consumption on those premises, provided that the audience does not exceed 500.
 - o a performance of amplified live music between 08:00 and 23:00 on any day, in a workplace that is not licensed to sell alcohol on those premises, provided that the audience does not exceed 500.
 - o a performance of amplified live music between 08:00 and 23:00 on any day, in a church hall, village hall, community hall, or other similar community premises, that is not licensed by a premises licence to sell alcohol, provided that (a) the audience does not exceed 500, and (b) the organiser gets consent for the performance from a person who is responsible for the premises.
 - o a performance of amplified live music between 08:00 and 23:00 on any day, at the non-residential premises of (i) a local authority, or (ii) a school, or (iii) a hospital, provided that (a) the audience does not exceed 500, and (b) the organiser gets consent for the performance on the relevant premises from: (i) the local authority concerned, or (ii) the school or (iii) the health care provider for the hospital.
- **Recorded Music:** no licence permission is required for:
 - o any playing of recorded music between 08:00 and 23:00 on any day on premises authorised to sell alcohol for consumption on those premises, provided that the audience does not exceed 500.
 - o any playing of recorded music between 08:00 and 23:00 on any day, in a church hall, village hall, community hall, or other similar community premises, that is not licensed by a premises licence to sell alcohol, provided that (a) the audience does not exceed 500, and (b) the organiser gets consent for the performance from a person who is responsible for the premises.
 - o any playing of recorded music between 08:00 and 23:00 on any day, at the non-residential premises of (i) a local authority, or (ii) a school, or (iii) a hospital, provided that (a) the audience does not exceed 500, and (b) the organiser gets consent for the performance on the relevant premises from: (i) the local authority concerned, or (ii) the school proprietor or (iii) the health care provider for the hospital.

Continued from previous page...

- Dance: no licence is required for performances between 08.00 and 23.00 on any day, provided that the audience does not exceed 500. However, a performance which amounts to adult entertainment remains licensable.
- Cross activity exemptions: no licence is required between 08.00 and 23.00 on any day, with no limit on audience size for:
 - o any entertainment taking place on the premises of the local authority where the entertainment is provided by or on behalf of the local authority;
 - o any entertainment taking place on the hospital premises of the health care provider where the entertainment is provided by or on behalf of the health care provider;
 - o any entertainment taking place on the premises of the school where the entertainment is provided by or on behalf of the school proprietor; and
 - o any entertainment (excluding films and a boxing or wrestling entertainment) taking place at a travelling circus, provided that (a) it takes place within a moveable structure that accommodates the audience, and (b) that the travelling circus has not been located on the same site for more than 28 consecutive days.

Section 21 of 21

PAYMENT DETAILS

This fee must be paid to the authority. If you complete the application online, you must pay it by debit or credit card.

Premises Licence Fees are determined by the non-domestic rateable value of the premises.

To find out a premises non domestic rateable value go to the Valuation Office Agency site at http://www.voa.gov.uk/business_rates/index.htm

Band A - No RV to £4300 £100.00

Band B - £4301 to £33000 £190.00

Band C - £33001 to £8700 £315.00

Band D - £87001 to £12500 £450.00*

Band E - £125001 and over £635.00*

*If the premises rateable value is in Bands D or E and the premises is primarily used for the consumption of alcohol on the premises then you are required to pay a higher fee

Band D - £87001 to £12500 £900.00

Band E - £125001 and over £1,905.00

There is an exemption from the payment of fees in relation to the provision of regulated entertainment at church halls, chapel halls or premises of a similar nature, village halls, parish or community halls, or other premises of a similar nature. The costs associated with these licences will be met by central Government. If, however, the licence also authorises the use of the premises for the supply of alcohol or the provision of late night refreshment, a fee will be required.

Schools and sixth form colleges are exempt from the fees associated with the authorisation of regulated entertainment where the entertainment is provided by and at the school or college and for the purposes of the school or college.

If you operate a large event you are subject to ADDITIONAL fees based upon the number in attendance at any one time

Capacity 5000-9999 £1,000.00

Capacity 10000 -14999 £2,000.00

Capacity 15000-19999 £4,000.00

Capacity 20000-29999 £8,000.00

Capacity 30000-39000 £16,000.00

Capacity 40000-49999 £24,000.00

Capacity 50000-59999 £32,000.00

Capacity 60000-69999 £40,000.00

Capacity 70000-79999 £48,000.00

Capacity 80000-89999 £56,000.00

Capacity 90000 and over £64,000.00

* Fee amount (£)

315.00

DECLARATION

Continued from previous page...

- I/we understand it is an offence, liable on conviction to a fine up to level 5 on the standard scale, under section 158 of the licensing act 2003, to make a false statement in or in connection with this application.

Ticking this box indicates you have read and understood the above declaration

This section should be completed by the applicant, unless you answered "Yes" to the question "Are you an agent acting on behalf of the applicant?"

* Full name

* Capacity

* Date / /
dd mm yyyy

Once you're finished you need to do the following:

1. Save this form to your computer by clicking file/save as...
2. Go back to <https://www.gov.uk/apply-for-a-licence/premises-licence/epping-forest/apply-1> to upload this file and continue with your application.

Don't forget to make sure you have all your supporting documentation to hand.

IT IS AN OFFENCE LIABLE TO SUMMARY CONVICTION TO A FINE OF ANY AMOUNT UNDER SECTION 158 OF THE LICENSING ACT 2003, TO MAKE A FALSE STATEMENT IN OR IN CONNECTION WITH THIS APPLICATION

IT IS AN OFFENCE UNDER SECTION 24B OF THE IMMIGRATION ACT 1971 FOR A PERSON TO WORK WHEN THEY KNOW, OR HAVE REASONABLE CAUSE TO BELIEVE, THAT THEY ARE DISQUALIFIED FROM DOING SO BY REASON OF THEIR IMMIGRATION STATUS. THOSE WHO EMPLOY AN ADULT WITHOUT LEAVE OR WHO IS SUBJECT TO CONDITIONS AS TO EMPLOYMENT WILL BE LIABLE TO A CIVIL PENALTY UNDER SECTION 15 OF THE IMMIGRATION, ASYLUM AND NATIONALITY ACT 2006 AND PURSUANT TO SECTION 21 OF THE SAME ACT, WILL BE COMMITTING AN OFFENCE WHERE THEY DO SO IN THE KNOWLEDGE, OR WITH REASONABLE CAUSE TO BELIEVE, THAT THE EMPLOYEE IS DISQUALIFIED

OFFICE USE ONLY

Applicant reference number	Vivaldi
Fee paid	
Payment provider reference	
ELMS Payment Reference	
Payment status	
Payment authorisation code	
Payment authorisation date	
Date and time submitted	
Approval deadline	
Error message	
Is Digitally signed	<input type="checkbox"/>

< Previous 1 2 3 4 5 6 7 8 9 10 11 12 13 14 15 16 17 18 19 20 21 Next >

Consent of individual to being specified as premises supervisor

I Mr Irfan Tas
[full name of prospective premises supervisor]

of



[home address of prospective premises supervisor]

hereby confirm that I give my consent to be specified as the designated premises supervisor in relation to the application for

New Premises License
[type of application]

by

Mr Irfan Tas
[name of applicant]

relating to a premises licence Not known yet
[number of existing licence, if any]

for

Vivaldi Cafe & Restaurant
236 High Road
Loughton
IG10 1RB
[name and address of premises to which the application relates]

and any premises licence to be granted or varied in respect of this application made by

Mr Irfan Tas
[name of applicant]

concerning the supply of alcohol at
Vivaldi Cafe & Restaurant
236 High Road
Loughton
IG10 1EB

[name and address of premises to which application relates]

I also confirm that I am applying for, intend to apply for or currently hold a personal licence, details of which I set out below.

Personal licence number

Application in progress
[insert personal licence number, if any]

Personal licence issuing authority

L.B. of Hackney
[insert name and address and telephone number of personal licence issuing authority, if any]

Signed



Name (please print)

Mr Irfan Tas

Date

09.05.2017

236 High Rd, Loughton IG10 1RB

Proposed Ground Floor Plan

Date	Total Area	Scale	Sheet
09.05.2017	114 sqm	1:100 @A4	1 of 1
Designed by	Checked		Date
EDE	MHR		
No	Revision note		

LEGEND

- LICENSABLE AREA
- WC AREA
- ALCOHOL
- FRIDGES
- SOFT DRINKS
- SAFETY LIGHTS
- SMOKE DETECTOR
- CCTV
- FIRE ESCAPE KEEP CLEAR
- INTERNALLY ILLUMINATED FIRE ESCAPE SIGN (BS 5266)
- CARBON DIOXIDE FIRE EXTINGUISHER
- 8.1.1. WATER FIRE EXTINGUISHER

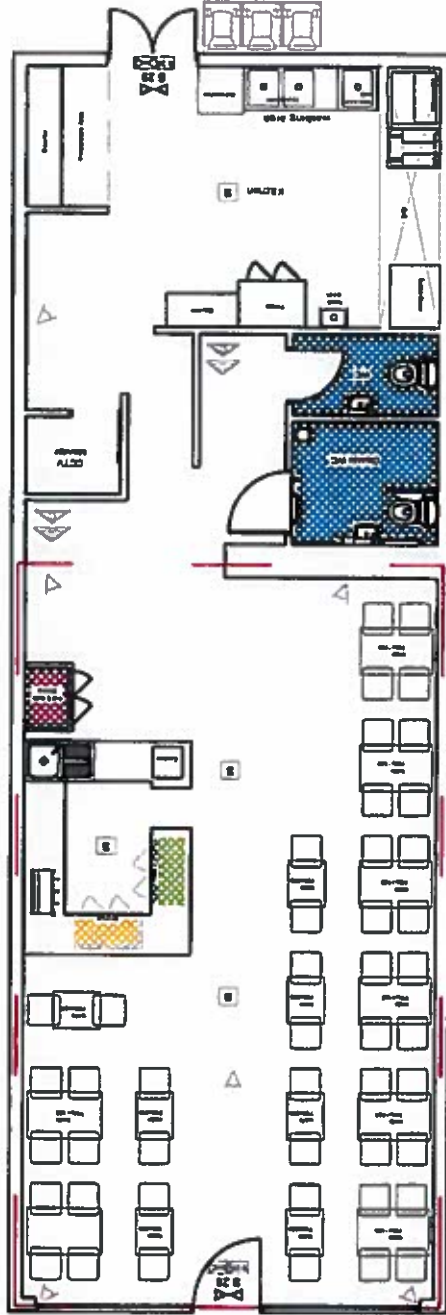

NARTS Amirvan
 Voice of Turkish & Kurdish Food Industry in Britain
 53 Belsa Northampton High Street, London N18 8EL.
 Tel: 020 7241 3535 | Mob: 07940 414 850 | www.narts.org.uk | info@narts.org.uk

Copyright Narts Food & Leisure LTD is the subject of Intellectual Property Rights including copyright and design right and shall not be reproduced, copied, loaned or submitted to other party without the written consent of Narts Food & Leisure LTD.
 Only Exact dimensions to be taken Any Discrepancies to be reported to Narts Food & Leisure LTD prior to setting out or ordering of any materials.



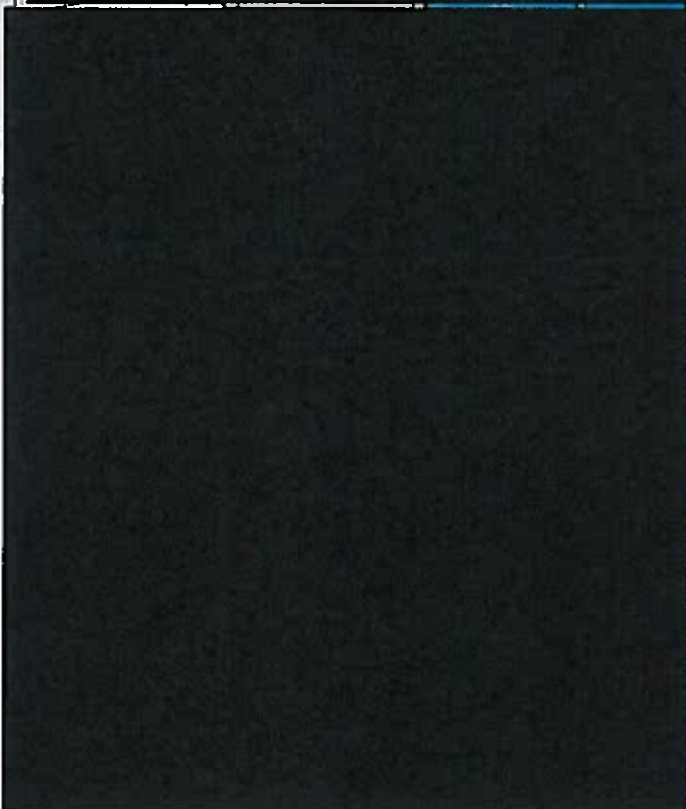
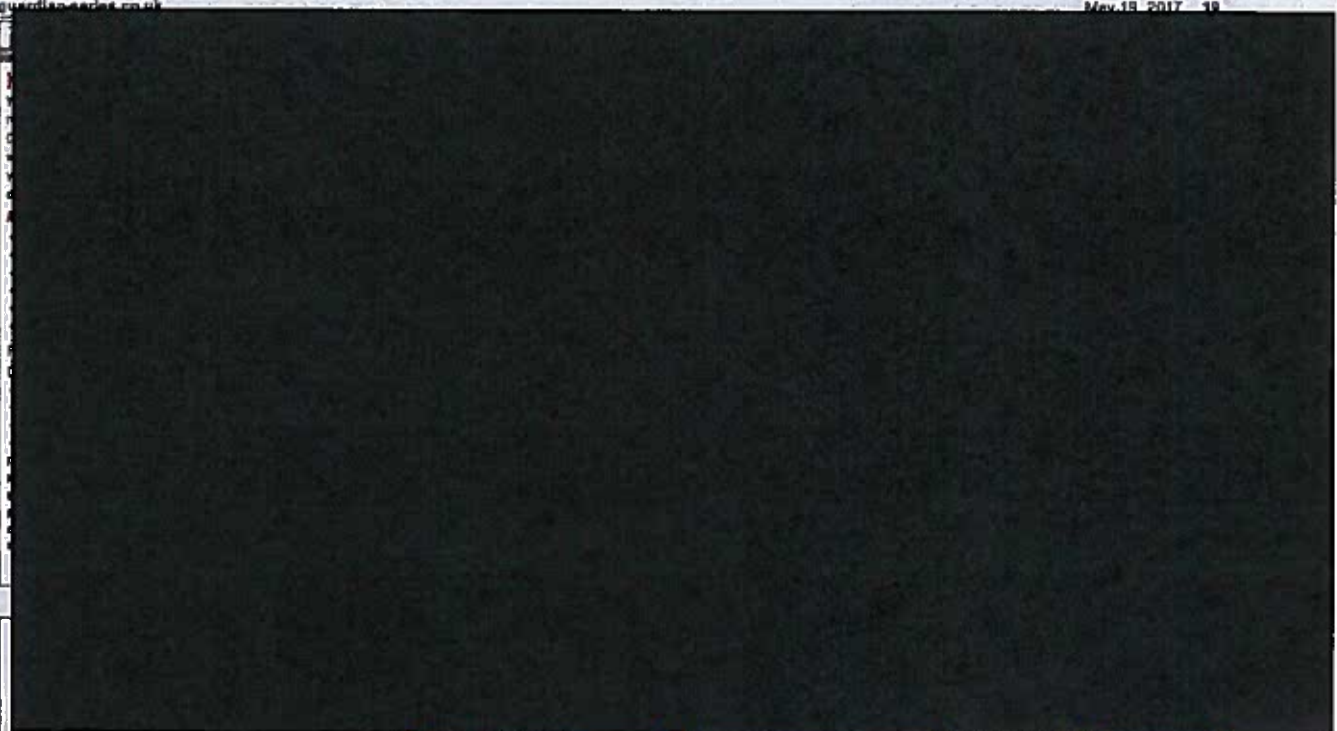

Your next hire is here.
 Advertise your vacancy today.
 Call 0203 581 3587

L1 jobs.com INDEPENDENT

The new home for jobs in London

Notice of Assignment for a
 Copyright Clearance Center
 License
 Please Note: This notice is for the
 purpose of informing you of the
 availability of a license for the use of
 the content of this document. The
 license is available for a fee of \$1.00
 per copy. For more information, visit
 the Copyright Clearance Center website
 at www.copyright.com.
 Copyright Clearance Center, Inc.
 222 Rosewood Drive
 Danvers, MA 01923
 (978) 750-8400
 www.copyright.com

60% of
 jobseekers
 apply in
 their local
 paper

L1 jobs.com

Your
 next hire
 is here

Call
 0203 581 3587

33% of our readers have
 considered or applied to
 a job advert in the last
 month.

Your next hire is here.
 Advertise your vacancy today.
 Call 0203 581 3587

L1 jobs.com INDEPENDENT

The new home for jobs in London

Year	Q1	Q2	Q3	Q4	Total
2018	100	120	150	180	550
2019	110	130	160	190	590
2020	120	140	170	200	630
2021	130	150	180	210	670
2022	140	160	190	220	710
2023	150	170	200	230	750
2024	160	180	210	240	790
2025	170	190	220	250	830
2026	180	200	230	260	870
2027	190	210	240	270	910
2028	200	220	250	280	950
2029	210	230	260	290	990
2030	220	240	270	300	1030



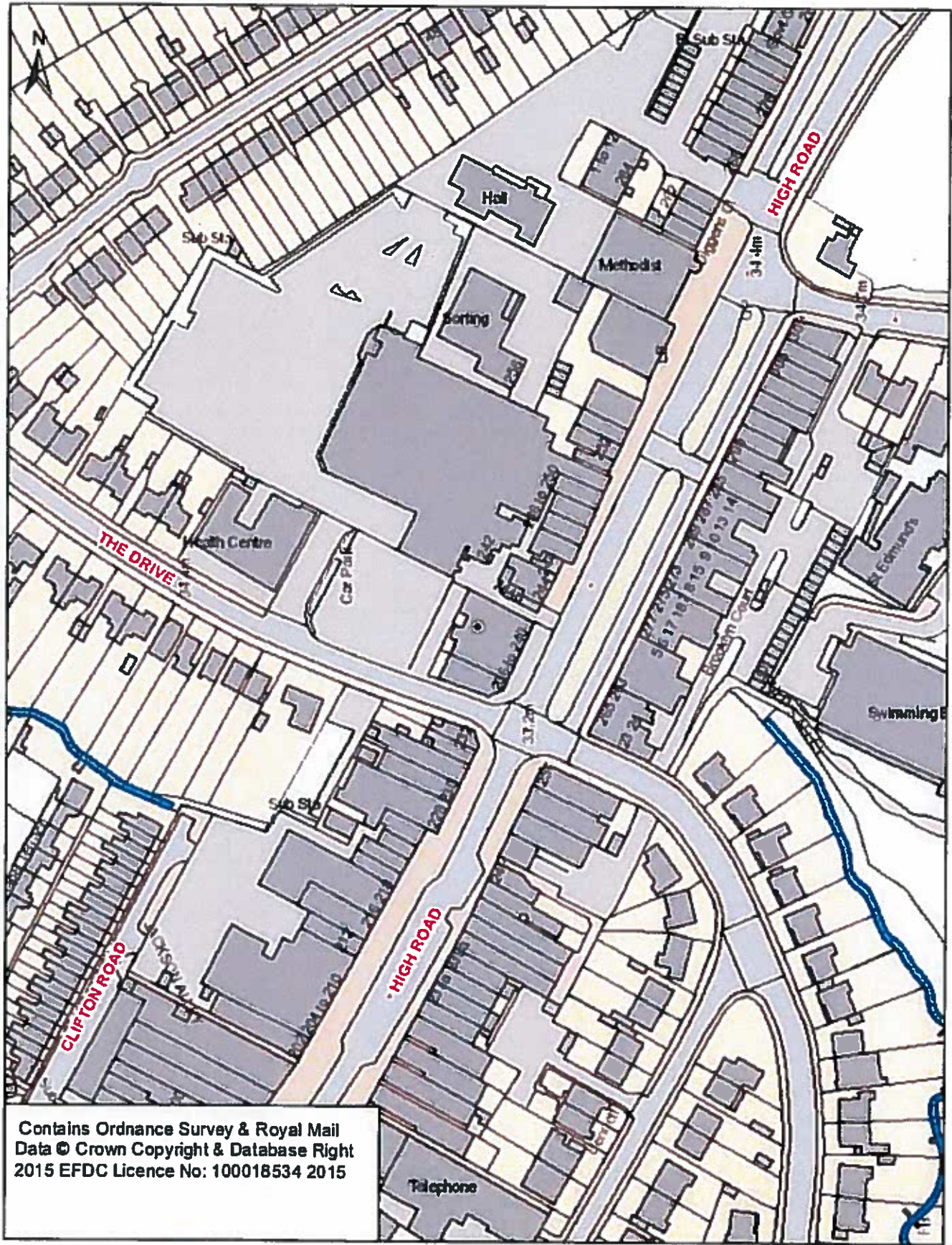

Contains Ordnance Survey & Royal Mail
 Data © Crown Copyright & Database Right
 2015 EFDC Licence No: 100018534 2015



**Epping Forest
 District Council**

236 High Road Loughton

Date: 08/06/2017

Scale: 1:1,500

Name: arcgis

[REDACTED]

From: Debra Paris <Debra.Paris@loughton-tc.gov.uk>
Sent: 24 May 2017 12:08
To: Licensing
Subject: Application Responses

Dear Sir/Madam,

Please find below the Town Council's comments on recent applications:

[REDACTED]

Vivaldi, 236 High Road, Loughton IG10 1RB

The Town Council OBJECTED to this application and stated that, given the residential nature of this location and for the prevention of public nuisance, the licensing hours on Saturdays and Sundays should be the same as for Mondays – Fridays, i.e. 9am – 11.30pm.

Thank you for your attention. Kindly confirm receipt of this email.

Regards,
Debra Paris
Planning and Licensing Committee Clerk
Loughton Town Council
1 Buckingham Court, Rectory Lane, Loughton, Essex IG10 2QZ
Tel: 020 8508 4200
Fax: 020 8508 4400
E-mail contact@loughton-tc.gov.uk
Web: www.loughton-tc.gov.uk



Disclaimer: This e-mail may contain confidential and/or privileged information. If you have received it in error, please notify the sender and delete it from your system. Any unauthorised use, disclosure or copying is not permitted. Please be aware that e-mail communication is not guaranteed to be secure. This e-mail has been checked for viruses but no responsibility is accepted for any damage caused by transmission of this e-mail. Opinions expressed may be those of the author and do not necessarily represent the view of Loughton Town Council.

Handan Ibrahim

From: Judy Jennings <clrjjennings@hotmail.co.uk>
Sent: 24 May 2017 17:46
To: Handan Ibrahim
Subject: Re: New Premises Application For Vavaldi, 236 High Road, Loughton, IG10 1RB

Dear Mrs Ibrahim

As this is a residential area with flats above the late night licence at the weekend is not appropriate I would hope to see a closure at. More reasonable time in line with other restaurants in the High Road From Cllr Judy Jennings St Mary's Ward

Sent from my iPhone

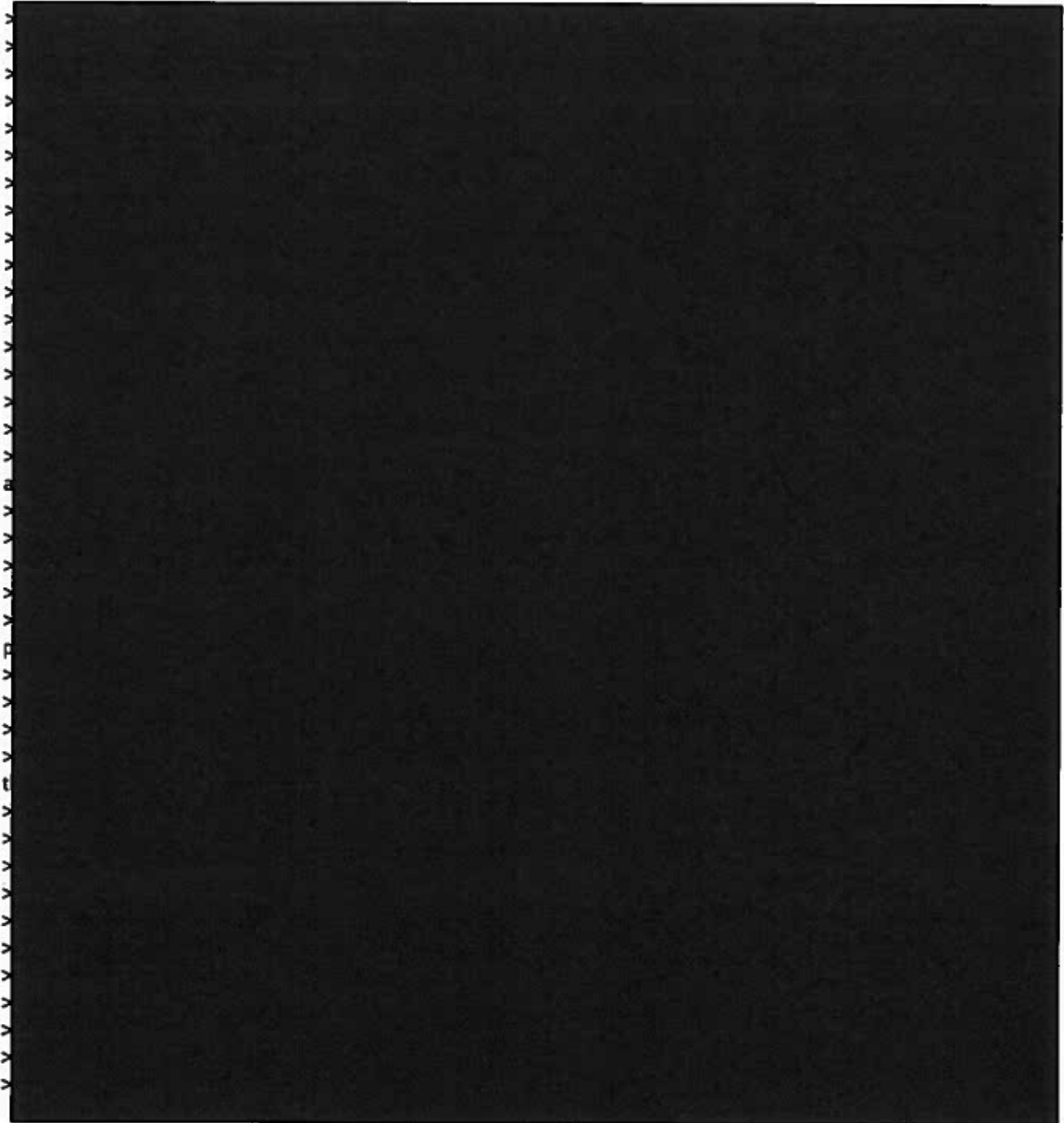

Scott Crawford (Mr)
[REDACTED] Priory Road
Loughton [REDACTED]

29 May 2017

The Licensing Team
Epping Forest District Council
Civic Offices, High Street
Epping, Essex
CM16 4BZ

Dear sir or madam,

I write to object to the recent license application from Mr Irfan Tas regarding Vivaldi, at 236 High Road in Loughton. I have several grounds for objection to the proposal:

- Prevention of crime and disorder,
- Prevention of public nuisance, and
- Protection of children from harm

Please note this location is closely surrounded by many residential properties, including several families such as mine, with young children. We know that late night drinking of the sort proposed will inevitably cause significant noise and disturbance to the residential neighbours as the inebriated patrons leave the premises.

It is worth noting that nearby licensed business (such as The Last Post) have legal restrictions prohibiting sale of alcohol after 11pm for just this reason. A similar restriction should apply here, and certainly the proposed closing time of 00:30 is at least 90 minutes beyond what is fair and reasonable.

It is also worth noting the many recent criminal acts of violence which forced police to take action against Luxe, further down the high road. There is clearly an violent criminal population which is within reach of Loughton and it makes no sense to invite them in with alcohol licensing far beyond hours which would be associated with a restaurant which was actually focused on dining. Despite the supposed application for a "café restaurant", it is clear from the hours here that a rowdy, late night drinking establishment is actually what is proposed.

Please reject this proposal outright and encourage the applicant to file again with a genuine restaurant application which would involve closing for business at 10 pm.

Thank you



Handan Ibrahim

From: [REDACTED]
Sent: 31 May 2017 21:59
To: Licensing
Cc: david.linnell
Subject: Vivaldi 236 High Road Loughton

Mr Colin Corrigan

[REDACTED] Brooklyn Avenue

Loughton

Essex

[REDACTED]
31st May 2017

Dear Sir/Madam

Vivaldi, 236 High Road, Loughton, IG10 1RB

I am writing to you to make representation against the application by Mr Irfan Tas in respect of the above premises.

Whilst the town is well served in respect of cafes/restaurants, I do not object on the grounds of the business type. Indeed I am pleased to see a new business joining the high street so promptly after the demise of the previous business at those premises.

My concerns arise from the lateness of the alcohol license that is being sought. The closing times (or cease trading?) times of 23:30 / 00:30 are more akin to those of a bar rather than a cafe/restaurant and I am concerned that any portrayal of the business as a eatery will erode over time as the serving of alcohol becomes more core to the business model. I therefore object on the following basis:

- The potential for the business to become perceived by customers as a bar. Late night bars in this town have been well documented in recent years as being locations for serious crime and disorder and, with the authorities now appearing to have made significant progress in recent months with dealing with the problems at these venues, I am concerned that the trouble will relocate to Vivaldi;

- The front of the premises open straight on to the pavement and issues caused by excessive alcohol intake could have serious interaction with passing pedestrians and motorists; and
- The property has no parking. Therefore customers will seek to park in nearby streets, most notably The Drive and my own road, Brooklyn Avenue. This of course is not in itself an issue as it is an essential part of the make-up of a town. However, I think it is unreasonable that householders should have to be disturbed by activity around cars at such a late hour, impacting negatively on work and schooling, etc.

I trust that you will pass this representation to the sub-committee and I await any further communications of relevance.

Yours sincerely

A solid black rectangular box used to redact the signature of the sender.

